



LED Spot EcoMax

- Fixed spotlight range with universal 68 mm cut-out
- Direct replacement for majority of halogen spotlights
- Over 85% savings of energy costs compared to halogen 35W and 50W
- Available in matte white and brushed aluminium finishes
- Can be used in e.g. bathrooms and related environments



Specifications

Item Code	Item Description	Equivalent to (W)	Power (W)	Lumen	Efficacy (lm/W)	CCT (K)	Beam angle	Weight (kg/pc)
140054076	LEDspotRF-E 4.5W-2700-36D-AL-CT	Halogen 35W	4.5	330	73	2700	36°	0.08
140054077	LEDspotRF-E 4.5W-4000-36D-AL-CT	Halogen 35W	4.5	350	78	4000	36°	0.08
140054078	LEDspotRF-E 4.5W-2700-36D-WH-CT	Halogen 35W	4.5	330	73	2700	36°	0.08
140054079	LEDspotRF-E 4.5W-4000-36D-WH-CT	Halogen 35W	4.5	350	78	4000	36°	0.08
140055457	LEDspotRF-E 7W-2700-36D-AL	Halogen 50W	7	510	73	2700	36°	0.08
140055458	LEDspotRF-E 7W-4000-36D-AL	Halogen 50W	7	530	76	4000	36°	0.08
140055459	LEDspotRF-E 7W-2700-36D-WH	Halogen 50W	7	510	73	2700	36°	0.08
140055460	LEDspotRF-E 7W-4000-36D-WH	Halogen 50W	7	530	76	4000	36°	0.08

Technical Specifications

Lifespan (L70B50)	30,000 h
Lifespan (L80B50)	20,000 h
On-/Off-cycles	100,000
Colour consistency (SDCM)	4
Dimmable	No
Finishing	Brushed aluminum front, matte black back / Matte white
Colour rendering index CRI	≥ 80
Degree of protection (IP)	IP44
IP recessed part	IP20
Impact strength	IK02
Protection class	II
Risk group	RGO
Control gear included	Yes
Glow wire test	850 °C
Driver failure rate (at 5,000 hrs)	1 %
Power factor	≥ 0.90

Electrical Supply

Frequency	50/60 Hz
Nominal voltage	220-240 V AC
DC input voltage	Yes, see Appendix 2

Mechanical Properties

Material housing	Aluminium
Optical material	Polycarbonate

Ambient Conditions

Operating temperature	-25 ~ 40 °C
Application temperature	25 °C
Storage environment	-25 ~ 50 °C

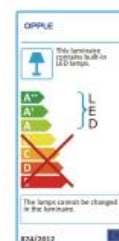

Dimensional Drawing (mm)

LEDspotRF-E

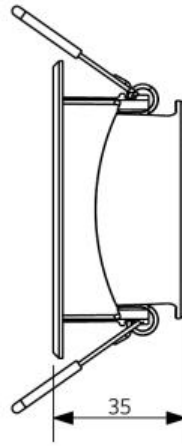
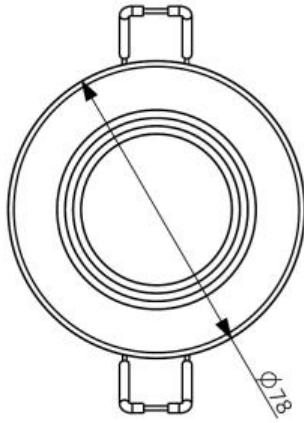

Installation Opening Drawing (mm)

LEDspotRF-E
Ø68

