

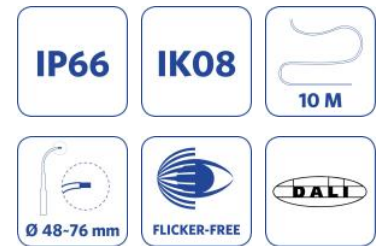

LED Roadlight

- NEW: Available with step dimming or DALI dimming for increased energy savings
- Up to 60% energy saving compared to HID roadlights
- Advanced optical design optimized for road lighting
- Flexible and adjustable pole connector for both side entry and pole top mounting
- Robust die-cast aluminium body
- IP66 and coastline proof



Roadlight standard without pole adapter.

Specifications

Item Code	Item Description	Equivalent to (W)	Power (W)	Lumen	Efficacy (lm/W)	CCT (K)	Weight (kg/pc)
543014005800	LEDRoadlight-90W-4000-DALI	HID 150W	90	11250	125	4000	9.00
543014005700	LEDRoadlight-120W-4000-DALI	HID 150W	120	15000	125	4000	9.20
543014005600	LEDRoadlight-150W-4000-DALI	HID 250W	150	18750	125	4000	9.20
543014005500	LEDRoadlight-200W-4000-DALI	HID 250W	200	24000	120	4000	9.40
543014015700	LEDRoadlight-90W-4000-STEP	HID 150W	90	11250	125	4000	9.00
543014015900	LEDRoadlight-120W-4000-STEP	HID 150W	120	15000	125	4000	9.20
543014015600	LEDRoadlight-150W-4000-STEP	HID 250W	150	18750	125	4000	9.20
543014015800	LEDRoadlight-200W-4000-STEP	HID 250W	200	24000	120	4000	9.40

Accessories



543098007000
Pole Adapter-Roadlight-60mm

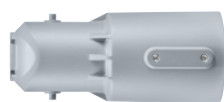

599006051700
Pole Adapter-Roadlight-76mm

Technical Specifications

Lifespan (L70B50)	70,000 h
On-/Off-cycles	100,000
Colour consistency (SDCM)	6
Dimmable	Yes / Yes (DALI)
Beam angle	150 ° x 70 °
Maximum tilt angle	15 °
Finishing	Grey
Colour rendering index CRI	≥ 80
Degree of protection (IP)	IP66
Impact strength	IK08
Protection class	I
Control gear included	Yes
Glow wire test	850 °C
Driver failure rate (at 5,000 hrs)	0.5 %
Power factor	≥ 0.90
Surge protection	10 kV

Electrical Supply

Frequency	50/60 Hz
Nominal voltage	220-240 V AC
DC input voltage	Yes, see Appendix 3

Mechanical Properties

Material housing	Aluminium
Optical material	Polycarbonate
Compatible pole Ø	48-76 mm
Effective wind area	1478 cm ²

Ambient Conditions

Operating temperature	-30 ~ 50 °C
Application temperature	25 °C
Storage environment	-30 ~ 65 °C

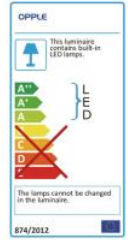

Dimensional Drawing (mm)

LEDRoadlight

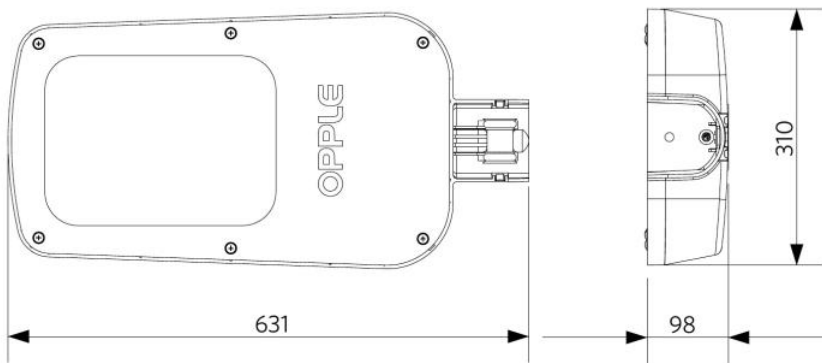

Pole Adapter-Roadlight-60mm

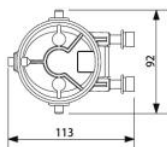
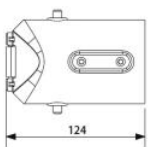

Pole Adapter-Roadlight-76mm

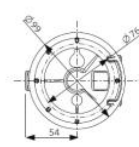
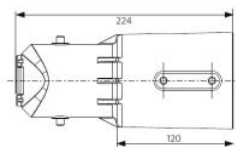

LEDRoadlight Tilting

